

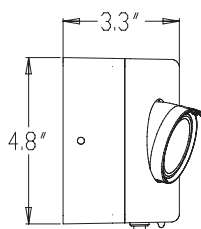

TP- 100-Plus

Wall Mount

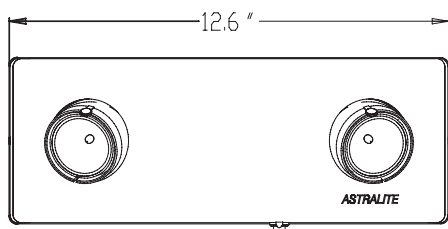

*Note: To determine Maximum Remote Wattage, Subtract total integral lamp Watts from total DC Unit Wattage.
Example: 25 Watts (Total DC Wattage) minus 20 Watts (2X10 Watt Lamps) Equals 5 Watts Maximum available for remote lamps. So, this unit can run an additional 5 Watt remote lamp

TYPE _____
CATALOG# _____

TP-100-Plus
Up To 25 (NICAD) Watts At 6 Volts
Heavy Duty Remote Capable
Emergency Battery Unit

GENERAL DESCRIPTION

The Light Style™ Series TP-100-Plus thermo plastic unit is your solution to eliminate the unsightly toolbox design normally associated with remote capability. Unit features 2 fully adjustable MR16 lamps within a sleek contoured low profile design while allowing you up to 25 watts of total unit power.

HOUSING

UV Stable Thermo Plastic flame retardant meets UL standard 95-VA. Installation is one of the industry's fastest. Standard white or black finishes that which match all products in the same family. Patent pending.

ILLUMINATION

Two 5 Watt MR-16 Halogen lamps (10 Watt Optional) mounted in precision formed fully adjustable assemblies exceed illumination required by UL 924 with better space to mounting criteria than the industry standard 5.4 Watt incandescent offering.

ELECTRONICS & BATTERY

Standard transformer input is dual voltage 120/277 60Hz. The charging system features Low Voltage Disconnect (LVD), AC lockout installation, brown out protection, and standard AC indicator LED light. With an average life of 5 years, the maintenance free sealed lead calcium battery provides a minimum of 90 minutes of illumination in emergency mode. Optional Nickel Cadmium battery is also available.

CODE COMPLIANCE

Tested and Listed to UL 924. Meets or exceeds NFPA, NEC, and OSHA illumination standards.

WARRANTY

5 years on housing and electronics with a 5 year pro rated warranty on battery.

LIGHT STYLE™ SERIES

TP-100-Plus				
Model	Total DC Wattage/ Battrery Type	Integral Lamps	Housing Color	Factory Installed Options
	22 Watts Sealed Led	-10 (2) 5 Watt MR16	W White	220 220 VAC Input
	16 Watts Nicad	-20 (2) 10 Watt MR16	B Black	*A Ammeter
	25 Watts Nicad			*V Voltmeter
				SD Self Diagnostics
				CP Canopy
				**TD Time Delay
				Note: * Select one
				** TD Must Specify AC
				Input Voltage and Delay Time
				in Minutes.

