

Description

Compact emergency lighting unit features low profile installation through side mounted heads. Choice of round or rectangular style lighting heads offered.

Features

- Compact, low profile design
- Side mounted, glare-free lighting heads
- Choice of round or rectangular lighting head styles
- Steel housing in neutral cream finish
- Maintenance-free lead calcium battery
- 90 Minutes of emergency illumination
- Universal 120/277VAC input
- Fully automatic, temperature compensating, variable rate float charger standard
- Automatic low voltage battery disconnect protects battery from deep discharge
- Automatic brownout protection
- AC lockout feature reduces installation time
- Optional self-diagnostic circuit available
- Momentary test switch
- AC ready indicator
- Meets NFPA Life Safety Code 101, NEC, OSHA, State and local Codes
- UL924 listed



Model XC-1

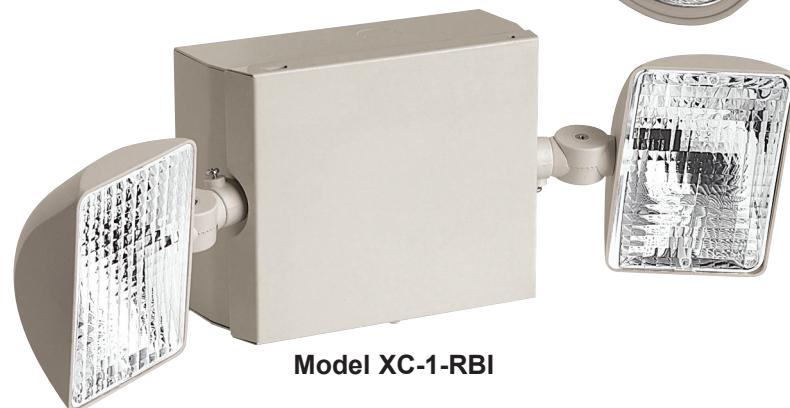

Model XC-1-RBI

Ordering Guide

Model No.	Volts	Watts For 1 1/2 Hrs.	Watts For 2 Hrs.	Watts For 3 Hrs.	Watts For 4 Hrs.	Standard Lamp	Weight (Lbs.)
Lead Calcium Battery Models							
XC-1	6	12	--	--	--	5.4W (-25)	7
XC-1-RBI	6	12	--	--	--	5.4W (-25)	6
Nickel Cadmium Battery Models							
XCN-1	6	10.8	--	--	--	5.4W (-25)	7
XCN-1-RBI	6	10.8	--	--	--	5.4W (-25)	6

NOTE: All product specifications shown are subject to change without notice.

Options⁽¹⁾⁽²⁾

Add Suffix	Description
-V	Voltmeter
-LC1	3-Conductor Line Cord - 120VAC
-LC2	3-Conductor Line Cord - 277VAC
-220	220VAC, 50Hz Input
-B	Black Finish
-SP	Special Paint Finish - Specify Color
-SX	Self-Diagnostic Circuit

(1) Other options available. Consult factory.

(2) Some options may impact product UL listing. Consult factory.

Specifier Reference

Project: _____

Fixture Type: _____

Model No.: _____

Comments: _____

Accessories

Order Model	Description
PG-1	Wire Guard
VERS	Vandal/Environmental Shield
VERS-4X	Vandal/Environmental Shield with Gasket

Construction

Housing: Heavy duty steel cabinet is finished in neutral cream baked-on powder paint providing scratch and corrosion resistance. Optional black (-B) and special color paint (-SP) finishes are available, see Options on front for ordering details.

Lighting Heads: Impact resistant, UV stable, flame rated thermoplastic lamp housing and swivel assemblies in neutral cream color to match unit housing. Lighting heads are fully adjustable and feature lockable swivels.

Installation

Mounting: Units are designed for mounting to walls by means of keyhole slots provided in the back of the unit housing.

Wiring: Knockouts are provided in the back of the housing for rear wiring from standard 3 1/2" and 4" electrical boxes. Surface wiring is also provided for by conduit knockouts in the top and right hand side of the unit housing.

Illumination

High output incandescent lamps maximize illumination characteristics through a specially designed reflector and glass lens assembly that provides glare-free trapezoidal light distribution.

Lamp Type: Incandescent - wedge base

Lamp Rating: 6 volt, 5.4 watt

Lamp Life: 100 hours (expected average)

Code Information

All models are UL924 Listed and meet NFPA 101 Life Safety Code, NEC, OSHA, Local and State Codes

Charger and Electronics

Charger Type: Fully automatic, temperature compensating, variable rate float charger

Utility Input: 120/277VAC, 60 Hz.

Power Consumption: 15 watts (maximum)

Temperature Range: 68°F to 86°F (20°C to 30°C)

Recharge Duty Cycle: 24 hours

Load Transfer: A solid state transfer circuit provides load connection.

Controls: Momentary test switch and LED AC-On indicator light

Safety Circuitry:

AC Lockout: Prevents battery discharge prior to initial unit power-up saving installation time.

Low Voltage Battery Disconnect: Protects the battery from being severely damaged by deep discharge during prolonged power failures.

DC Overload and Short Circuit Protection: Provided by a disconnect circuit that automatically resets itself when the fault condition is corrected.

Brownout Protection: Automatically switches the unit to emergency mode when utility voltage is reduced to the point at which most fluorescent light fixtures would extinguish.

Emergency Operation

Upon failure of the normal utility power, a solid-state transfer switch automatically connects the unit's battery to the emergency lamps. Emergency illumination will be supplied for a minimum of 90 minutes

Dimensions

Model XC-1

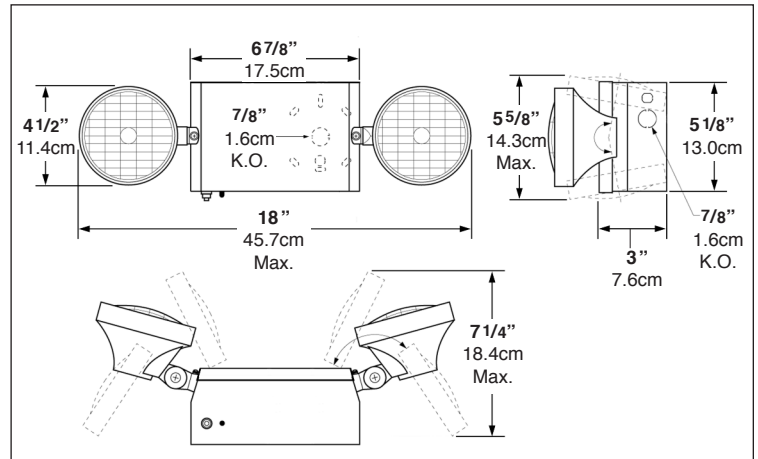

Model XC-1-RBI

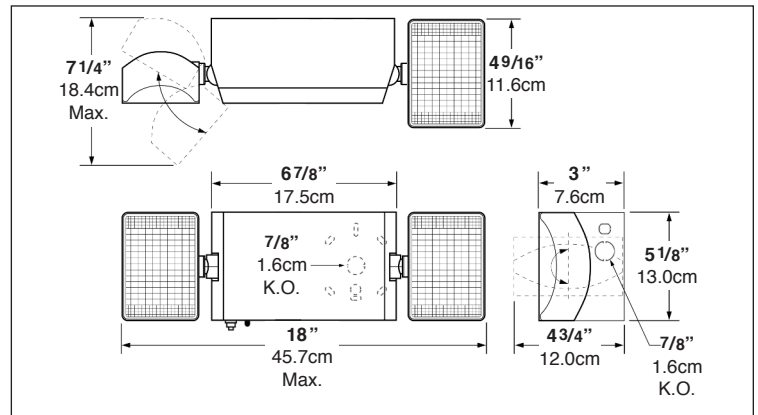

During emergency operation, the unit battery is protected from severe discharge damage by an automatic low voltage disconnect circuit that discontinues unit operation when battery voltage reaches 87.5% of nominal. When normal utility power is restored, the battery is automatically disconnected from the load and a recharging cycle begins that will return the battery to full capacity within 24 hours.

Optional Self-Diagnostic Circuit

The optional SX self-diagnostics circuit automatically cycles the emergency lighting unit every 25-30 days. The SX circuit checks for battery charging and over charging, battery capacity and reports any system malfunction. By design the SX does not activate the lighting heads, thus avoiding substantial lamp life reduction.

Battery

Models are offered which provide either standard duty **lead calcium** or longest life **nickel cadmium** batteries. Both battery types are fully maintenance free and designed to provide many years of dependable service.

Warranty

Unit: (excluding lamps) 3-years full coverage against defects in materials and workmanship from date of shipment

Battery: 3 years full warranty plus an additional 7 years of pro-rata coverage