

PE12V3AF1



Specifications

Nominal Voltage	12 V
Rated Capacity (20 hour rate)	3 Ah
Weight	2.87 lbs. (1.30 kg)
Case Material	Synthetic Resin (ABS)

Dimensions

Length	5.28 inch (134.0mm)
Width	2.64 inch (67.0mm)
Height	2.40 inch (61.0mm)
Total Height	2.56 inch (65.0mm)

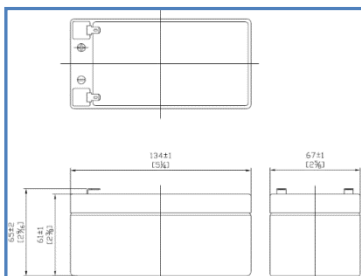

Standard Terminal
F1 : AMP Fasten
Type 187

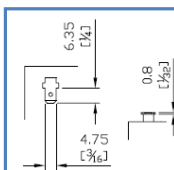

Characteristics

Energy Density	1.08Watt-hours/cubic inch
Specific Energy	12.6 Watt-hours/pound
Maximum Discharge Current with Standard Terminals	18 A
Maximum Short Duration Discharge Current	45 A (less than 5 sec.)
Vibration Test	No Loss Capacity or Performance (2000 cycles/minute, 0.10 excursion, 2 hours)
Charge Retention (Shelf Life)	% of Nominal Capacity at 77°F (25°C) 1 month 97% 3 month 90% 6 month 80%
Recommended Ambient Temperature Range	Charge : 32°F (0°C) to 104°F (40°C) Discharge : -4°F (-20°C) to 122°F (50°C) Storage : -4°F (-20°C) to 104°F (40°C)
Internal Resistance of Fully Charged Battery	60milliohms

Charging

Recommended Charging Methods	CYCLE USE : Maximum Initial Charge Current : 750mA Charging Voltage : 14.4 ~14.7V Charge Should Be Switched to Float Mode or Disconnected When Current Drops to 30mA
	STANDBY USE (Float) : Maximum Initial Charge Current : 750mA Charge Voltage : 13.5 ~13.8V

End of Discharge Voltage		Discharge Time										
		10M	15M	30M	1H	2H	3H	4H	5H	8H	10H	20H
10.8V	W	72.49	54.27	31.54	18.82	11.11	8.06	6.49	5.43	3.68	3.08	1.70
	A	5.97	4.51	2.58	1.54	0.91	0.66	0.53	0.45	0.30	0.25	0.14
10.5V	W	75.85	56.92	32.56	19.46	11.49	8.31	6.70	5.60	3.80	3.18	1.76
	A	6.28	4.73	2.66	1.58	0.95	0.68	0.55	0.46	0.31	0.26	0.15
10.2V	W	79.56	59.48	33.57	20.05	11.83	8.56	6.91	5.76	3.92	3.27	1.81
	A	6.56	4.92	2.74	1.63	0.98	0.70	0.57	0.47	0.32	0.27	0.16
9.6V	W	85.77	63.44	35.65	21.32	12.55	9.11	7.34	6.11	4.16	3.48	1.92
	A	7.08	5.23	2.92	1.75	1.04	0.75	0.60	0.50	0.34	0.28	0.16