

PRODUCT OVERVIEW

The REGINA 2 series of fluorescent fixtures have the rugged durability needed to perform in hostile environments. The silicon gasketing that seals the fixture from moisture contributes to the NEMA 4X / Marine 595 ratings (HT model). The Regina 2 series is a 2 foot fixture and features the patented "Plug-in" connection system, the REGINA 2 combines both versatility and ease of installation.

EXTERNAL SPECIFICATIONS

The REGINA 2 fluorescent lighting fixture is constructed from high quality corrosion, flame and vandal resistant polycarbonate. The UV stabilized, clear rubberized prismatic lens helps ensure durability and superior illumination. Flush reinforced exterior latch clips and a "hot-bonded" liquid silicon gasket effectively seal the REGINA from the ingress of moisture.

REFLECTOR

The REGINA 2 series has a UV stabilized polycarbonate reflector that supports components including the ballast and lamp holders.

DIFFUSER

The REGINA 2 diffuser is UV stabilized to reduce the yellowing index and provide superior light output. The REGINA 2 comes standard with a clear prismatic diffuser. On average, an increase of +10% light output is achieved by using the clear prismatic diffuser.

INSTALLATION

The REGINA 2 luminaire is suitable for ceiling, wall, suspension & pendant mount. Suitable for wet location installations on normally inflammable surfaces.

ORDERING INFORMATION

Series	Operation	Lamp 2 Foot Lamps	Ballast Available	Input Voltage	Options
82	HT <i>(AC only)</i>	A <i>(1x17w T8)</i>	HT, SE, SA	US <i>(120v)</i>	TP <i>(tamper proof kit)</i>
	SE <i>(emergency only)</i>	B <i>(2x17w T8)</i>	HT, SE, SA	US2 <i>(277v)</i>	FP <i>(fuse protection)</i>
	SA <i>(AC & emergency)</i>	C <i>(2x14w T5)</i>	HT, SE, SA		
		D <i>(2x24w T5 HO)</i>	HT		
		E <i>(1x55w PL)</i>	HT		

EXAMPLE: 82-HT-E-US
DESCRIPTION: Regina, AC only, 1x55w compact fluorescent, 120 volt.



DIMENSIONS (in.)

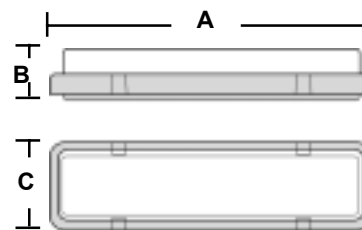

Wattage	A"	B"	C"
1x17W	26"	6 1/2"	4 1/4"
2x17W	26"	6 1/2"	4 1/4"
2x14W	26"	6 1/2"	4 1/4"
2x24W	26"	6 1/2"	4 1/4"
1x55W	26"	6 1/2"	4 1/4"



UL924 Listed
Damp & Wet
NEMA 4x
MARINE 595
CSA Certified

Regina 2 Technical Data

LAMP TECHNOLOGY

The REGINA 2 series of fixtures can be configured with linear fluorescent T8, T5 and biaxial compact fluorescent lamps. Providing the greatest amount of flexibility to best match your application requirements. Fixtures can be ordered in either single or double lamp versions.

HOUSING

The REGINA 2 series utilizes a durable injection molded, self-extinguishing polycarbonate housing. Lightweight and durable, the REGINA 2 is ideal for use in areas where materials such as steel and aluminum may deteriorate. The reinforced closure latch clasps are incorporated into the housing resulting in a clean appearance while securely locking the diffuser to the housing. A liquid silicon gasket is "hot-bonded" to the REGINA 2 housing during manufacturing, this properly seals the entire fixture.

DIFFUSER

The REGINA 2 incorporates a UV stabilized, clear rubberized prismatic lens diffuser, providing superior light output and impact resistance. Making use of a clear prismatic lens can contribute up to +10% greater luminous distribution over other translucent lens materials. This permits increased spacing between fixtures and improves overall performance efficiency.

REFLECTOR

The REGINA 2 foot reflector is made of UV stabilized polycarbonate. The reflector supports components including the ballast and lamp holders. All components attach to the reflector, allowing for easy installation and maintenance.

MOUNTING FLEXIBILITY

The REGINA 2 has been designed for optimal flexibility when utilizing a standard surface mount conduit configuration. The REGINA 2 also has knockouts for pendant or chain suspension mounting. The diffuser can be quickly and easily removed and remounted during installation without the need for any specialized tools via the integral latch clasps. Polycarbonate construction results in a very lightweight fixture that can be easily held in place while being installed.

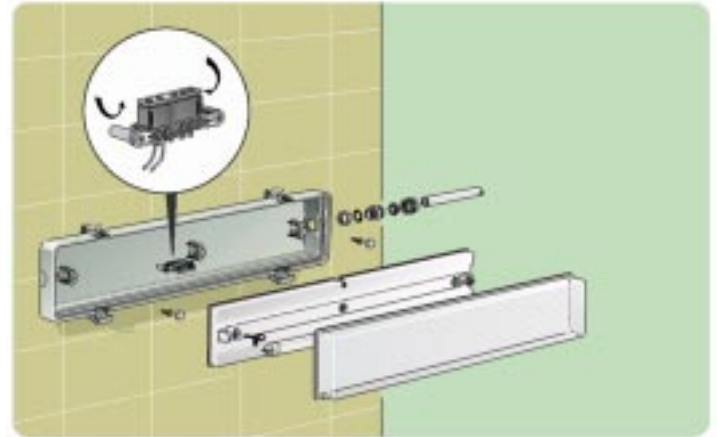

Quick Connect Speeds Installation Time

IP65 / WET LOCATION GASKETING

The REGINA 2 series (HT) carries NEMA 4X / EEMAC 4X / Marine 595 ratings due to the advanced liquid silicon gasketing that completely seals the unit from moisture infiltration. Ceiling mounted lighting fixtures like the REGINA 2 are especially vulnerable to fire sprinkler activation since lighting and emergency lighting units are often installed right next to sprinkler heads. The REGINA's NEMA 4X / Marine 595 ratings ensure protection not just from ambient moisture, but also from jets of water like those given off by broken or activated sprinkler heads.

WARRANTY

The REGINA 2 comes from the factory with an unconditional 5 year product warranty. Lamps are not covered.