



nexus<sup>®</sup> NEMA-4X



TYPE: \_\_\_\_\_  
 CATALOG #: \_\_\_\_\_  
 NOTES: \_\_\_\_\_

## HP Series

### NEMA-4X, High-Performance Industrial Battery Unit

#### Features

- Fiberglass gray housing with captive screws. It is designed for heavy-duty industrial applications: indoors, outdoors, hose-down areas, cold-storage facilities etc
- NEMA-4X protection grade against liquids and windblown dust
- Wide ambient temperature range: standard 32°F to 122°F (0°C to 50°C) in high temperature Lead-Calcium and 50°F to 104°F (10°C to 40°C) in Nickel-Cadmium; optional cold-weather -40°F to 122°F (-40°C to 50°C)
- High-efficacy LED emergency heads outperform traditional 50W incandescent lamps
- Innovative head design: four-LED and dual-driver provide illumination even in case of unexpected component failure
- Compact size: 0.46 cubic feet
- Product feature stainless steel on all outside hardware
- Simple and easy to install on walls, poles, columns, struts, on vertical position for poles or columns use mounting bracket (order separately catalog number: PMK1-E)
- May be wired from top or side (see drawing beside for position)
- Standard infrared remote test control included in all models: allow to test the equipment without need to climb a ladder. Functional up to 30 ft distance. Universal, one Remote Test Control may test all units on the job.
- Non-Audible Advanced Diagnostic and Self-Test standard in all models
- Optional NEXUS<sup>®</sup> central monitoring system
- UL924 Listed
- 5 Year limited warranty  
 Detailed warranty terms located at: [http://www.emergi-lite.com/usa/files/EL\\_Warranty.pdf](http://www.emergi-lite.com/usa/files/EL_Warranty.pdf)

#### Power Consumption: maximum current draw

TEMPERATURE	SPECS
Standard temperature range	120/277VAC, 60Hz, 0.30/0.15A
Cold-Weather option	120/277VAC, 60Hz, 0.70/0.35A

#### Unit Rating

MODEL	WATTS TO 87-1/2% OF RATED BATTERY VOLTAGE*			
	1-1/2 hrs	2 hrs	3 hrs	4 hrs
12HPM30	30	20	15	10
12HPM60	60	40	30	20
12HPN40	40	36	24	18
24HPN90	90	72	48	36

Note: the cold-weather option is only rated for 90 minutes.

#### Remote Test Control



#### Dimensions

Dimensions are approximate and subject to change.

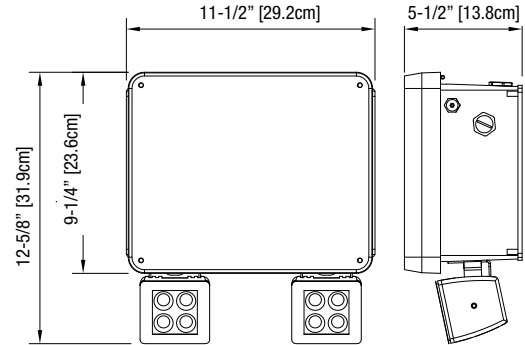

#### Installation

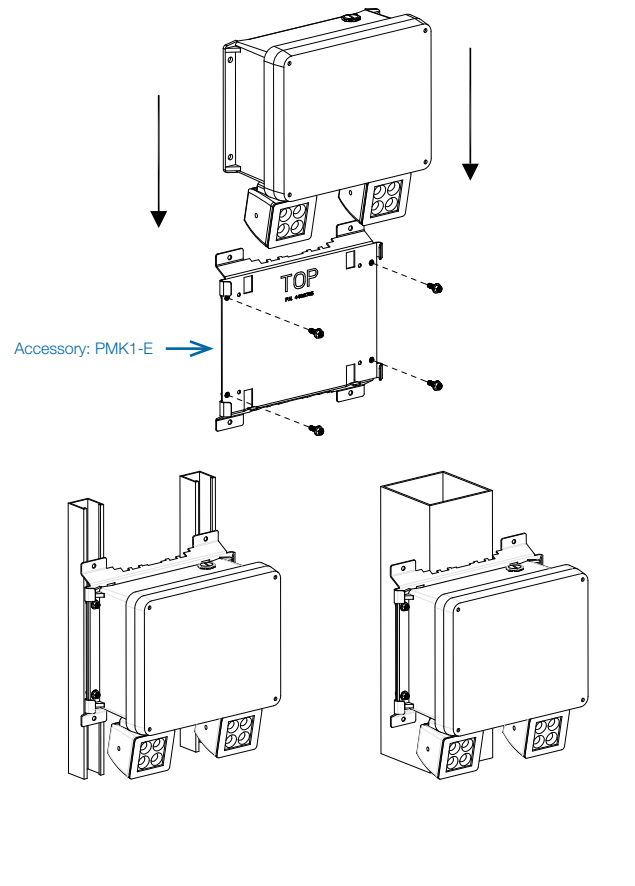

TYPE: \_\_\_\_\_  
 CATALOG #: \_\_\_\_\_  
 NOTES: \_\_\_\_\_



# HP Series

## NEMA-4X, High-Performance Industrial Battery Unit

### Photometry Performance

Whether installed indoors or outdoors, the HP Series of LED emergency lights deliver a stable and consistent illumination on the path of egress for a wide range of mounting heights. Depending on the application, one may select and specify among three level of lumen output and cross reference to traditional incandescent emergency lights below.

LED HEAD	POWER	TOTAL LUMENS	OUT-PERFORM SPACING OF THE INCANDESCENT
L6	6W	565	35W PAR36, MR16 Halogen
L10	10W	1000	50W PAR36, MR16 Halogen
L15	15W	1300	50W MR16-IR Halogen

Industrial environment: wall mounted equipment, reflectances: 10/10/10; 6-ft wide illumination path. 200 ft X 200 ft X 30 ft space. Illumination as per NFPA101; Average: 1fc; Min: 0.1fc; Max/min< 40:1

MOUNTING HEIGHT	SPACING CENTER-TO-CENTER (FEET)		
	LAMP L6 / 6W, 565LM	LAMP L10 / 10W, 1000LM	LAMP L15 / 15W, 1300LM
10 ft	80	110	140
15 ft	70	105	135
20 ft	60	100	130
25 ft	50	95	120

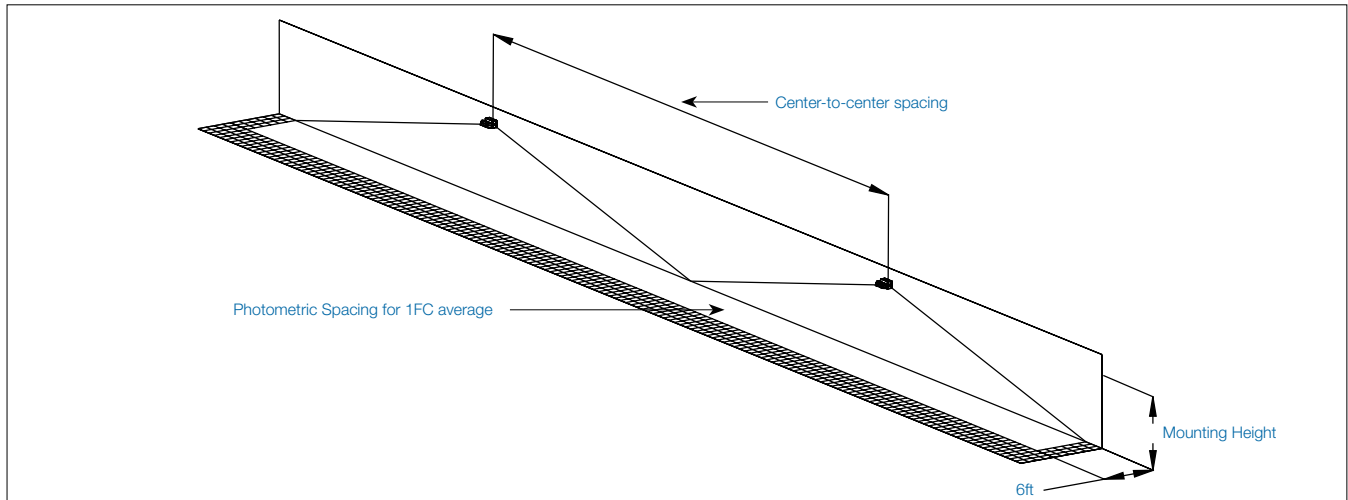

### How to Order

SERIES	BATTERY TYPE AND CAPACITY	# OF HEADS	LED HEADS	DIAGNOSTIC	OPTIONS
12HP= High-Performance	<b>M30</b> = 12V-30W, High temperature Lead-Calcium battery, Temperature= 32°F to 122°F [0...50°C]	0= No head 1= One head 2= Two heads	<b>L6</b> = 12-24V, 6W (565 Lumens) <b>L10</b> = 12-24V, 10W (1000 Lumens) <b>L15</b> = 12-24V, 15W (1300 Lumens)	<b>D</b> = Advanced Diagnostic, non-audible* <b>DA</b> = Advanced Diagnostic, audible <b>NEX</b> = NEXUS® wired <b>NEXRF</b> = NEXUS® wireless	<b>CW4</b> = Cold-Weather -40°F [-40°C]* <b>D3</b> = Time Delay 15 minutes <b>RFI</b> = Radio frequency interference filter
	<b>M60</b> = 12V-60W, High temperature Lead-Calcium battery, Temperature= 32°F to 122°F [0...50°C]				
	<b>N40</b> = 12V-40W, Nickel-Cadmium battery, Temperature= 50°F to 104°F [10...40°C]				
24HP= High-Performance	<b>N90</b> = 24V-90W, Nickel-Cadmium battery, Temperature= 50°F to 104°F [10...40°C]			* Standard	* Only 12V equipment

Example: 12HPN402L6DRFI

TYPE: \_\_\_\_\_  
 CATALOG #: \_\_\_\_\_  
 NOTES: \_\_\_\_\_



# HP Series

## NEMA-4X, High-Performance Industrial Remote Unit

### Features

- Die-Cast gray housing and heads designed for heavy-duty industrial applications: indoors, outdoors, hose-down areas, cold-storage facilities etc
- Can be installed in all temperature conditions: -40°F to 131°F (-40°C to 55°C)
- NEMA-4X protection grade against liquids and windblown dust
- High-efficacy LED emergency heads outperform traditional 50W incandescent lamps
- Innovative head design: four-LED and dual-driver provide illumination even in case of unexpected component failure
- Simple and easy to install on walls, poles, columns, struts, on vertical position for poles or columns use mounting bracket (order separately catalog number: PMK1-E)
- UL924 Listed
- 5 Year limited warranty

Detailed warranty terms located at: [http://www.emergi-lite.com/usa/files/EL\\_Warranty.pdf](http://www.emergi-lite.com/usa/files/EL_Warranty.pdf)

### Dimensions

Dimensions are approximate and subject to change.

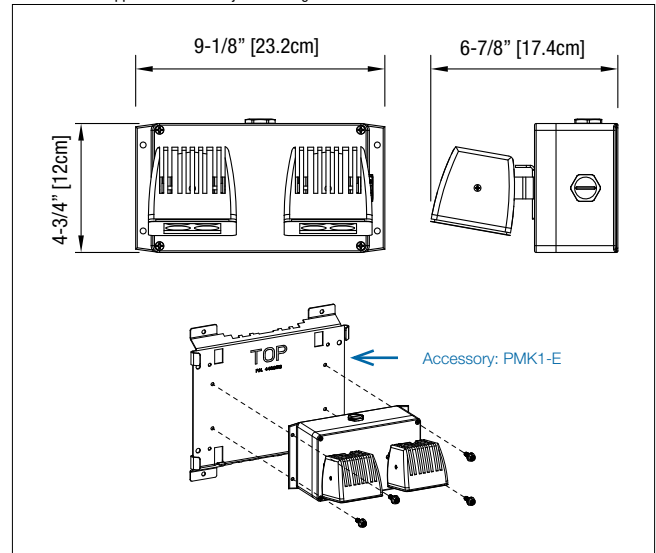

### Photometry Performance

Whether installed indoors or outdoors, the HP Series of LED emergency lights deliver a stable and consistent illumination on the path of egress for a wide range of mounting heights. Depending on the application, one may select and specify among three levels of lumen output. See cross reference to traditional incandescent emergency lights below.

LED HEAD	POWER	TOTAL LUMENS	OUT-PERFORM SPACING OF THE INCANDESCENT
L6	6W	565	35W PAR36, MR16 Halogen
L10	10W	1000	50W PAR36, MR16 Halogen
L15	15W	1300	50W MR16-IR Halogen

Industrial environment: wall mounted equipment, reflectances: 10/10/10; 6-ft wide illumination path.  
 Illumination as per NFPA101; Average: 1fc; Min: 0.1fc; Max/min < 40:1

MOUNTING HEIGHT	SPACING CENTER-TO-CENTER (FEET)		
	LAMP L6 / 6W, 565LM	LAMP L10 / 10W, 1000LM	LAMP L15 / 15W, 1300LM
10 ft	80	110	140
15 ft	70	105	135
20 ft	60	100	130
25 ft	50	95	120

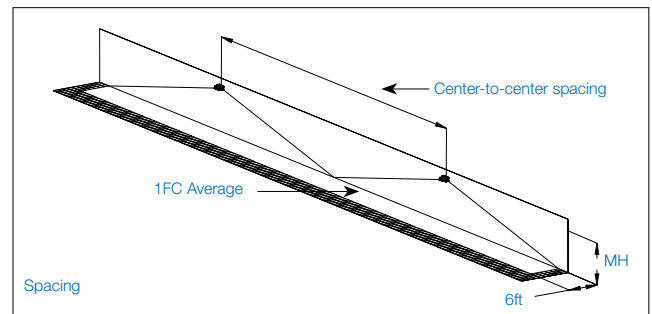

### How to Order

SERIES	NUMBER OF HEADS	LED HEAD
HPR= High-Performance Remote	D= Double head	L6 = 12-24V – 6W (565 Lumens) L10 = 12-24V – 10W (1000 Lumens) L15 = 12-24V – 15W (1300 Lumens)

Example: HPRDL6