

PE6V3.2F1



Specifications

Nominal Voltage	6 V
Rated Capacity (20 hour rate)	3.2 Ah
Weight	1.65 lbs. (0.75 kg)
Case Material	Synthetic Resin (ABS)

Dimensions

Length	2.60 inch (66.0mm)
Width	1.30 inch (33.0mm)
Height	4.65 inch (118.0mm)
Total Height	4.88 inch (124.0mm)

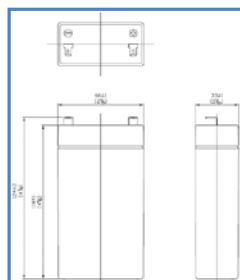

Standard Terminal
F1 : AMP Fasten
Type 187

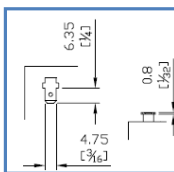

Characteristics

Energy Density	1.22 Watt-hours/cubic inch
Specific Energy	11.6 Watt-hours/pound
Maximum Discharge Current with Standard Terminals	19.2 A
Maximum Short Duration Discharge Current	48 A (less than 5 sec.)
Vibration Test	No Loss In Capacity or Performance (2000 cycles/minute, 0.10 excursion, 2 hours)
Charge Retention (Shelf Life)	% of Nominal Capacity at 77°F (25°C) 1 month 97% 3 month 90% 6 month 80%
Recommended Ambient Temperature Range	Charge : 32°F (0°C) to 104°F (40°C) Discharge : -4°F (-20°C) to 122°F (50°C) Storage : -4°F (-20°C) to 104°F (40°C)
Internal Resistance of Fully Charged Battery	40 Milliohms

Charging

Recommended Charging Methods	CYCLE USE : Maximum Initial Charge Current : 800mA Charging Voltage : 7.20 ~7.35V Charge Should Be Switched to Float Mode or Disconnected When Current Drops to 32mA
	STANDBY USE (Float) : Maximum Initial Charge Current : 800mA Charge Voltage : 6.75 ~6.90V

End of Discharge Voltage		Discharge Time										
		10M	15M	30M	1H	2H	3H	4H	5H	8H	10H	20H
5.40V	W	38.66	28.95	16.82	10.04	5.92	4.30	3.46	2.89	1.96	1.64	0.90
	A	6.37	4.81	2.76	1.64	0.97	0.70	0.57	0.48	0.32	0.27	0.15
5.25V	W	40.45	30.35	17.36	10.38	6.13	4.43	3.57	2.98	2.03	1.69	0.94
	A	6.70	5.04	2.84	1.69	1.01	0.72	0.59	0.49	0.33	0.28	0.16
5.10V	W	42.43	31.72	17.91	10.69	6.31	4.57	3.69	3.07	2.09	1.75	0.97
	A	7.00	5.25	2.92	1.74	1.04	0.75	0.60	0.50	0.34	0.28	0.17
4.80V	W	45.74	33.83	19.01	11.37	6.69	4.86	3.91	3.26	2.22	1.85	1.02
	A	7.55	5.58	3.12	1.86	1.11	0.80	0.64	0.53	0.36	0.30	0.18