

## PE6V7.2F1



### Specifications

Nominal Voltage	6 V
Rated Capacity (20 hour rate)	7.2 Ah
Weight	3.04 lbs. (1.38kg)
Case Material	Synthetic Resin (ABS)

### Dimensions

Length	5.94 inch (151.0mm)
Width	1.34 inch (34.0mm)
Height	3.70 inch (94.0mm)
Total Height	3.86 inch (98.0mm)

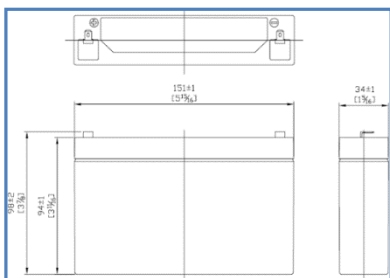

**Standard Terminal**  
F1 : AMP Fasten  
Type 187

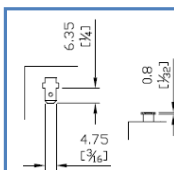

### Characteristics

Energy Density	1.47 Watt-hours/cubic inch
Specific Energy	14.2 Watt-hours/pound
Maximum Discharge Current with Standard Terminals	43.2 A
Maximum Short Duration Discharge Current	108 A (less than 5 sec.)
Vibration Test	No Loss Capacity or Performance (2000 cycles/minute, 0.10 excursion, 2 hours)
Charge Retention (Shelf Life)	% of Nominal Capacity at 77°F (25°C) 1 month 97% 3 month 90% 6 month 80%
Recommended Ambient Temperature Range	Charge : 32°F (0°C) to 104°F (40°C) Discharge : -4°F (-20°C) to 122°F (50°C) Storage : -4°F (-20°C) to 104°F (40°C)
Internal Resistance of Fully Charged Battery	32 Milliohms

### Charging

Recommended Charging Methods	<b>CYCLE USE :</b> Maximum Initial Charge Current : 1.8A Charging Voltage : 7.20 ~7.35V Charge Should Be Switched to Float Mode or Disconnected When Current Drops to 72mA
	<b>STANDBY USE (Float) :</b> Maximum Initial Charge Current : 1.8A Charge Voltage : 6.75 ~6.90V

End of Discharge Voltage		Discharge Time										
		10M	15M	30M	1H	2H	3H	4H	5H	8H	10H	20H
5.40V	W	86.98	65.13	37.85	22.59	13.33	9.67	7.79	6.51	4.41	3.69	2.03
	A	14.33	10.82	6.20	3.70	2.19	1.58	1.28	1.07	0.72	0.60	0.34
5.25V	W	91.02	68.30	39.07	23.35	13.78	9.97	8.04	6.71	4.56	3.81	2.11
	A	15.06	11.35	6.38	3.80	2.27	1.63	1.32	1.10	0.75	0.62	0.36
5.10V	W	95.47	71.38	40.29	24.06	14.19	10.27	8.29	6.92	4.70	3.93	2.17
	A	15.75	11.81	6.57	3.91	2.34	1.68	1.36	1.13	0.77	0.64	0.38
4.80V	W	102.92	76.12	42.78	25.59	15.06	10.94	8.80	7.33	4.99	4.17	2.30
	A	16.98	12.56	7.01	4.19	2.49	1.79	1.44	1.20	0.82	0.68	0.40