

Type No. _____
 Job Name _____
 Catalog No. _____



Shown: WLN1RBSCT



Wet Lok

- **Wet/Damp Location Exit Signs**
- **Cast Aluminum/Polycarbonate Vandal Resistant Construction**
- **AC Only and Self-Powered Models**
- **Standard Self-Testing Diagnostics**

Housing

- Die cast aluminum housing with premium impact-resistant injection molded polycarbonate covers
- Housing is powder coated and back cover is molded in color to match, front cover is clear
- Stencil is provided with field selectable chevrons and is contained inside the fully gasketed housing
- All exposed hardware is vandal resistant and anti-corrosion coated
- Universal knockouts on backplate allow wall mounting directly to standard junction boxes
- Die cast aluminum canopy is provided for top/end mounting and is powder coated to match housing
- Two knockouts are located on the frame to accommodate 1/2" flex or rigid conduit

Battery

- Maintenance free, sealed nickel cadmium battery has an expected life up to 10 years with an operating range of 40°F (-40°C) to 113°F (45°C)
- Supplies 120 minutes of emergency power
- Compliant with IEC 61951-1

Illumination

- Normal and emergency illumination is accomplished with long lasting, high output Light Emitting Diodes (LEDs)
- Hot spots and striations are eliminated by the internal "light chamber" especially designed around the high performance LED array
- Average illumination levels are in excess of 25fl (79 cd/m²)

Warranty

Electronics: 5 years
 Battery: 5 years full, 5 years pro-rata

Electronics

AC Only

- 120/277 VAC dual voltage input with surge protection standard

Self-Powered

- Charging system is microprocessor driven with software embedded diagnostic routine and temperature compensation
- See specification sheet L2465 for electronics details

Electrical Specifications

AC Only

Red – 3.8 watts (120 VAC), PF = 0.96, 3.8 watts (277 VAC), PF = 0.91
 Green – 4.0 watts (120 VAC), PF = 0.95, 4.0 watts (277 VAC), PF = 0.90

Self-Powered

Red – 4.7 watts (120 VAC), PF = 0.95, 4.8 watts (277 VAC), PF = 0.97
 Green – 4.7 watts (120 VAC), PF = 0.95, 4.7 watts (277 VAC), PF = 0.99

Smart Charger Self-Testing Diagnostics (standard)

- The Smart Charger diagnostic/charging platform with self-testing mode automatically runs a one-minute self-test every 30 days and a 30-minute test on the sixth and twelfth month. A one-minute or 90-minute test may be initiated via the push to test switch on the unit or by activating the appropriate test command on the optional IR test device.

Code Compliance

- UL 924 listed
- UL damp and wet location listing -40°F (-40°C) to 113°F (45°C)
- NFPA 101, NEC, BOCA, OSHA, and IBC illumination standards
- Meets ADA specifications for wall mounted lighting fixtures
- IEC 61951-1 Life Testing (batteries)
- Certified to the California Energy Commission in accordance with California law

Dimensions

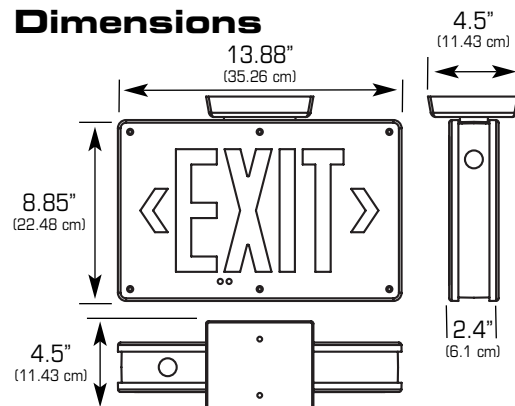

Dimensions are approximate and subject to change.

Ordering Information

W	L					SCT	
SERIES	LAMP TYPE	BATTERY	FACE OPTIONS	LETTER COLOR	STENCIL FACE/ HOUSING COLOR	MODEL DESIGNATOR	FACTORY INSTALLED OPTIONS
W = Wet Lok	L = LED	A = AC Only N = Nickel Cadmium	1 = Single U = Universal Single/Double Face	R = Red G = Green	W = White Stencil Face and Housing B = Black Stencil Face and Housing G = Gray Stencil Face and Housing WA = Brushed Aluminum Stencil Face and White Housing BA = Brushed Aluminum Stencil Face and Black Housing GA = Brushed Aluminum Stencil Face and Gray Housing	SCT = Smart Charger Self-Testing Diagnostic Electronics	A = Audible Diagnostics BF = Buzzer/Flasher (Self-Powered Only) BZ = DC Buzzer DC = 12-48 VDC Input (AC only models) EX = Special Input Transformer (Consult factory) ¹ FA = 24 VDC Fire Alarm Interface FL = Emergency Flasher (Self-Powered Only) PM = Pendant Mount Only (Must order pendant kit accessory) ² SW = Special Wording (Consult factory) 2CKT1 = 120 VAC Two Circuit (AC only models) 2CKT2 = 277 VAC Two Circuit (AC only models)

Note: 1) Some options may impact UL listing. Consult factory for specifics. 2) Must specify "PM" option for compatibility with pendant kit.

ACCESSORIES (Ordered Separately)
SCIR = Smart Charger Infra-Red Remote T15TPTOOL = Tamperproof Screwdriver WPKITB = Pendant Kit, 12" Stem, Black WPKITW = Pendant Kit, 12" Stem, White

Ordering Example

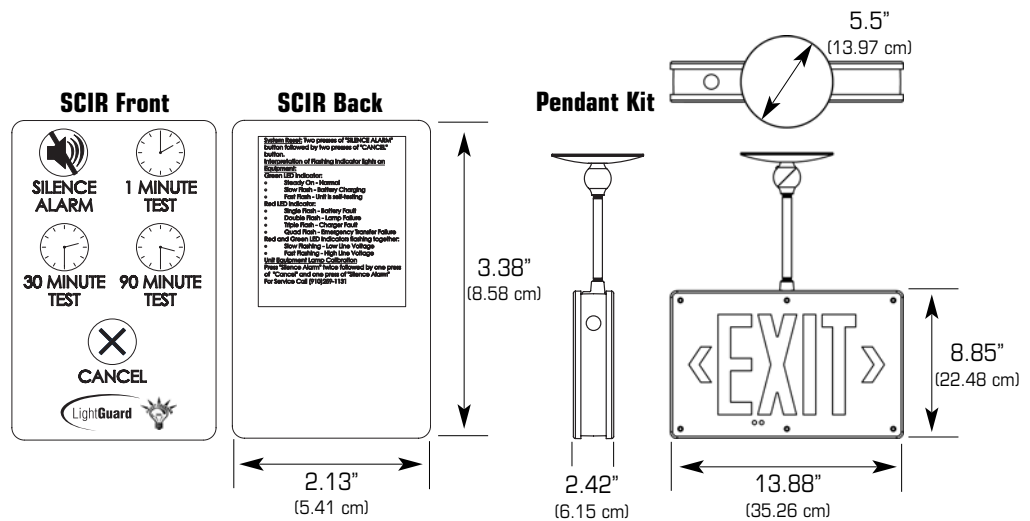
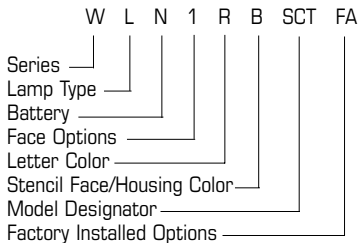

Suggested Specification

Furnish and install LightGuard LED exit sign model _____ . The exit shall be constructed to meet Underwriter's Laboratories, Inc. Standard #924 and the National Electrical Code (NEC).

INSTALLATION AND OPERATION – Exit shall be easily field connected to a 120 or 277 VAC, 60 hertz, unswitched power source. Installation must comply with the NEC as well as other applicable codes. (Self-Powered Only) – Upon utility power failure or brown out, the unit shall automatically transfer to battery power and maintain the required illumination level for a minimum period of 120 minutes. Upon restoration of utility power, the charger shall restore the battery to full charge within 24 hours.

ELECTRONICS AC-Only Models – The exit sign shall be easily field connected to 120 or 277 VAC, 60 HZ un-switched power source. The Wet Lok exit sign equipped with red LED's shall consume 3.80 watts with a power factor of 0.96 (120 VAC) and 3.80 watts with a power factor of 0.91 (277 VAC). The Wet Lok exit sign equipped with green LED's shall consume 4.00 watts with a power factor of 0.95 (120 VAC) and 4.00 watts with a power factor of 0.90 (277 VAC). Available, factory-installed options shall include a two-circuit module to accommodate 120/120 or 277/277 VAC for use with a generator or central inverter system; A fire alarm activated flasher option to accommodate an input from a fire alarm panel and provide a flashing rate when the alarm system is activated.

Self-Powered Models – All self-powered models shall be provided with LightGuard's Smart Charger self-testing diagnostics electronics platform. The exit sign shall be easily field connected to 120 or 277 VAC, 60 HZ un-switched power source. Smart Charger will detect and notify the installer regarding incorrect wiring of the transformer primary and restrict the damaging effects from affecting the printed circuit board. The Wet Lok exit sign equipped with red LED's shall consume 4.70 watts with a power factor of 0.95 (120 VAC) and 4.81 watts with a power factor of 0.97 (277 VAC). The Wet Lok exit sign equipped with green LED's shall consume 4.71 watts with a power factor of 0.95 (120 VAC) and 4.67 watts with a power factor of 0.99 (277 VAC). The Smart Charger electronics package shall provide continuous, real-time monitoring of all the critical equipment functions including, but not limited to: line voltage status and condition, charger fault, transfer fault, battery fault, and LED load fault and notify personnel with a visual indicator sequence. Optional audible diagnostics shall be available from the factory. The standard self-testing software shall satisfy the periodic testing requirements in NFPA 101, Life Safety Code as well as the International Building Code (IBC). The Smart Charger diagnostic/charging platform with self-testing mode automatically runs a one-minute self-test every 30 days and a 30-minute test on the sixth and twelfth month. The Smart Charger circuit shall continuously sample ambient temperature conditions and adjust the charging regime to compensate for typical and dramatic ambient conditions equal to 3mv/°C compensation to maximize the life of the battery. An on-board IR receiver shall be standard and pre-programmed to operate from an optional IR user interface device (available as an accessory item).

BATTERY (Self-Powered Models Only) – The battery shall be maintenance-free, sealed nickel cadmium utilizing sintered plate construction and polypropylene separators for trouble-free operation. The Wet Lok exit sign shall carry a UL damp and wet location listing for use in ambient conditions ranging from -40° F (-40° C) to 113° F (45°C). The battery shall be tested and recognized in accordance with the accelerated life testing requirements of the IEC standard 61951-1.

ILLUMINATION - The Wet Lok exit sign shall be illuminated by high-intensity, long-life LEDs. Average legend illumination shall be equal to or greater than 25 ft (79 cd/m²).

ENCLOSURE – The exit sign housing shall be constructed of a combination of heavy-duty die-cast aluminum and injection molded polycarbonate. The final housing finish shall be an epoxy-based, powder coat paint. The exit stencil face shall be constructed of aluminum sheet. Chevron selection shall be field selectable using knockouts in the stencil.

ALL SPECIFICATIONS SUBJECT TO CHANGE WITHOUT NOTICE



272 West Stag Park Service Road • Burgaw, NC 28425
(910) 259-1131 • FAX (800) 403-6927
www.lightguard.com

L2315R9
5/09 IH