

# SPECIFICATIONS

## CONSTRUCTION

- Engineering-grade polycarbonate housing is UV-stabilized, impact- and scratch-resistant and corrosion-proof.
- White, contemporary “soft-corners” housing.
- Two 7.2W wedge-base tungsten lamps (9W for CSA).
- Dual-voltage input capability (120/277V) (specify 120V or 347V for CSA).
- Gold-plated edge connectors on printed circuit board ensure long-term durability.
- Universal J-box mounting pattern.
- Low-profile, integrated test switch.
- Unique track and swivel arrangement permits full range of direction of lamp head adjustment.

## BATTERY

- Sealed, maintenance-free lead-calcium battery standard.
- Automatic recharge after a 30-minute (CSA) to 90-minute discharge.
- Low-voltage disconnect prevents excessively deep discharge that can permanently damage the battery.
- Single-circuit battery connection.
- Galvanized battery retaining clip.

## ELECTRONICS

- Current-limiting charger maximizes battery life and minimizes energy consumption. Provides low operating costs.
- Short-circuit protection — current-limiting charger circuitry protects printed circuit board from shorts.
- Thermal protection senses circuitry temperature and adjusts charge current to prevent overheating and charger failure.
- Thermal compensation adjusts charger output to provide optimum charge voltage relative to ambient temperature.
- Regulated charge voltage maintains constant-charge voltage over a wide range of line voltages. Prevents over/undercharging that shortens battery life and reduces capacity.
- Filtered charger input minimizes charge voltage ripple and extends battery life.
- AC/LVD reset allows battery connection before AC power is applied and prevents battery damage from deep discharge.

## CODES

- UL listed. Meets UL 924, NFPA 101-1991 (current Life Safety Code), NFPA 70-NEC. Listed and labeled to comply with Canadian Standards (see options).

## WARRANTY

- Three-year total customer satisfaction warranty.

Type

Catalog number

.....

.....

.....

# Polycarbonate Emergency Light

# 6ELM2/6ELM2P

## Lead-Calcium Battery

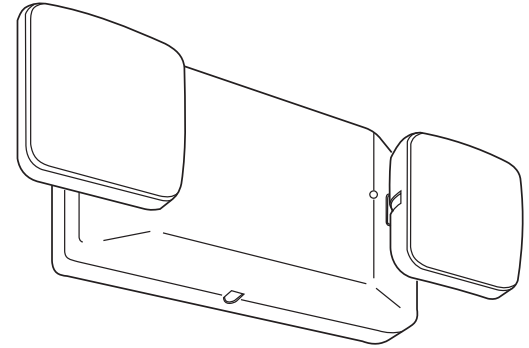

# ORDERING INFORMATION

Example: **6ELM2 H**

Family	Options	
<b>6ELM2</b>	<b>H</b> 8W halogen lamps	<b>LD</b> Load disconnect
<b>6ELM2P</b>	<b>B</b> Black housing	<b>120</b> 120 volts <sup>2</sup>
	<b>RO</b> Less lamp heads	<b>347</b> 347 volts <sup>2</sup>
	<b>N</b> Maintenance-free nickel-cadmium battery	<b>CSA</b> 4-foot cordset (120V only)
	<b>AM</b> Ammeter <sup>1</sup>	<b>CSA</b> Listed and labeled to comply with Canadian Standards <sup>3</sup>
	<b>VM</b> Voltmeter <sup>1</sup>	

NOTES:  
 1 Choice of AM or VM. Not available with both.  
 2 Only available with CSA option.  
 3 Not available with 6ELM2P.

### Accessories

Order as separate items.  
**ELA VS2** Polycarbonate vandal shield (1/8" thick)  
**ELA WG2M** Wireguard

# 6ELM2/6ELM2P Polycarbonate Emergency Light, Quantum

## SPECIFICATIONS

### ELECTRICAL

#### Primary Circuit

Type	AC Input			Output Volts	Watts Output			
	Volts	Amps	Watts		1/2hr.	1hr.	1-1/2hrs.	2hrs.
6ELM2	120	.167	20	6	*	*	16	12
	277	.072	20					
6ELM2 CSA	120	.10	11	6	36	18	12	9
	347	.04	12.7					
6ELM2P	120	.167	20	6	*	*	24	18
	277	.072	20					

\* Half hour and one hour run time not applicable for U.S. product.

### BATTERY

#### Nickel-Cadmium

Voltage	Shelf life <sup>1</sup>	Expected life <sup>1</sup>	Maintenance	Optimum temperature <sup>2</sup>
6	3 yrs.	10 yrs.	none <sup>3</sup>	32°-100°F (0°-37.8°C)

#### Sealed Lead-Calcium

Voltage	Shelf life <sup>1</sup>	Expected life <sup>1</sup>	Maintenance	Optimum temperature <sup>2</sup>
6	6 mos.	5-8 yrs.	none <sup>3</sup>	60-90°F (16-32°C)

1 At 77°F (25°C).

2 Optimum ambient temperature range where unit will provide capacity for 30 to 90 minutes. Higher and lower temperatures affect life and capacity. Consult factory for detailed information.

3 Periodic system status test recommended.

## MOUNTING

All dimensions are inches (millimeters).  
Shipping weight: 7.5 lbs. (3.4 kgs.)

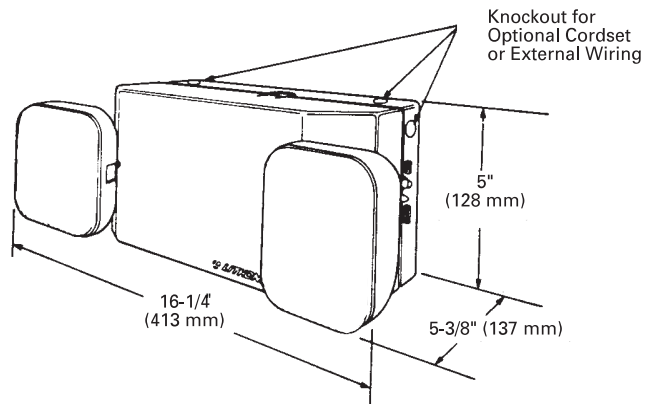

Housing Back

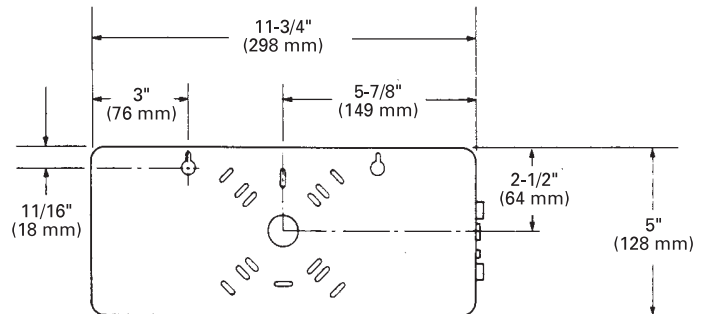

## KEY FEATURE

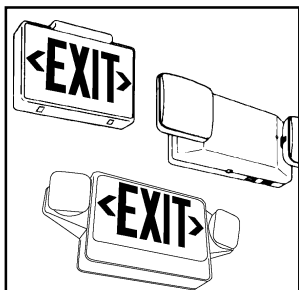

Compatible in appearance with full Quantum family.