

# Presc•lite

Life Safety Products

Type: \_\_\_\_\_

Housing supplied with four 1/2" openings - three top, one bottom. Close-up plugs included.

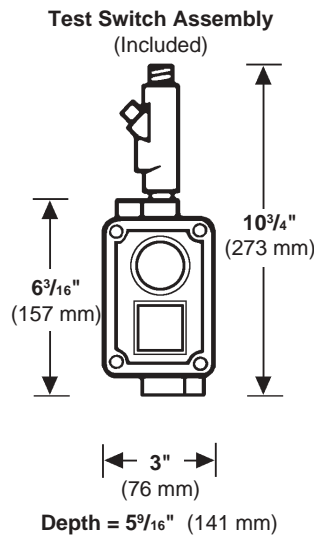
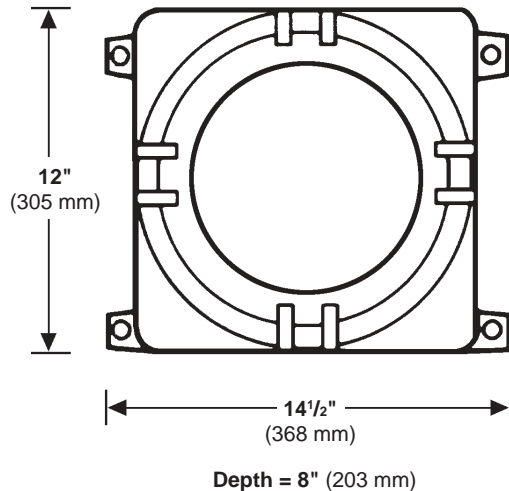

# XPBP Series

75W

6 and 12V  
Explosion-Proof  
Emergency Units

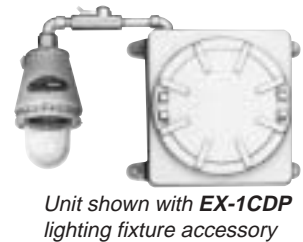

Ideal for installations requiring an explosion-proof emergency lighting unit designed for safe operation in the following hazardous environment applications:

NEC Class I, Div. 1 & 2, Groups C&D  
NEC Class II, Div. 1 & 2, Groups E, F&G  
NEC Class III



## Standard Features

- High-strength, copper-free aluminum housing
- Quick access thread-on cover
- Test switch included
- AC "ON" indicator
- Maintenance-free lead-acid battery
- 6- and 12-volt models
- 12-volt model allows longer wiring runs
- Capacity for remote fixtures
- Supplied standard without lighting fixtures
- 120/277VAC operation standard
- Fully automatic, solid-state charger
- Low-voltage battery disconnect
- Transformer isolation protection
- Optional fixtures available for a wide range of hazardous environments
- 90 minute operation
- Temperature range: 20°C to 30°C (68°F to 86°F)
- UL Listed to standard 924 and standard 844 (Hazardous Locations)

## Model Numbers

XPBP-75P (6V, 75W)  
12XPBP-75P (12V, 75W)

## Options (Add suffix to catalog number)

-TDR 15-minute retransfer delay (120VAC only)

## Accessories (Order Separately)

EX-1CDP Explosion-proof fixture for unit mounting<sup>(1)</sup>  
XWGP Globe guard for explosion-proof lighting fixture  
REX-SDRP Standard dome reflector<sup>(2)</sup>  
REX-ARP Angled dome reflector<sup>(2)</sup>  
EX100CDP Auxiliary housing with exit legend for use with explosion-proof fixture

<sup>(1)</sup> Includes all necessary mounting fittings and hardware.

<sup>(2)</sup> Requires field modifications of fittings for use with EX-1CDP fixture.



EX100CDP auxiliary exit housing - Fixture not included



Hubbell Lighting, Inc.

## Housing:

The XPBP Series is an explosion-proof emergency lighting power unit, providing "normally off" operation of optional unit-mounted or remote lighting fixtures. It is designed, tested and UL Listed to function safely in the presence of hazardous gases, vapors and dusts. Unit construction is a cast junction box of high-strength, copper free aluminum capable of containing any internal electrical arc or arc-generated explosions without subjecting the external hazardous environment to the by-products of any such occurrence. Designed for easy installation, the unit is provided with four mounting holes for attachment to a wall or other suitable surface. Housing is drilled and tapped for installation of utility AC conduit. Quick access to internal wiring and components is provided by a thread-on cover. All necessary fittings for the test switch/pilot light module supplied standard.

All XPBP Series units are listed for operation in:

|                      |                     |
|----------------------|---------------------|
| <b>NEC Class</b>     | <b>Group Rating</b> |
| Class I, Div. 1 & 2  | Groups C & D        |
| Class II, Div. 1 & 2 | Groups E, F & G     |
| Class III            |                     |

## Light Source

Lighting fixtures must be ordered separately (see below).

## Accessory Lighting Fixtures

XPB-75 unit is designed for the direct attachment or remote connection of explosion-proof accessory lighting fixtures.

Up to two, EX1-CDP explosion-proof lighting fixtures can be attached directly to the XPBP Series power unit housing. EX1-CDP fixtures are rated for use in environments where hazardous conditions are normally present (NEC Division I), or only present under unusual conditions such as accidents or leakage (NEC Division II). The fixture may be adapted to serve as an exit sign through the use of model EX100CD, Auxiliary Exit Housing. This housing fits directly over the globe of the explosion-proof fixture and attaches to its hub.

For specifications and ordering information on Remote Accessory Lighting Fixtures, refer to technical data sheet EL-43.

## Battery:

A maintenance free lead-acid battery is provided. The battery is completely sealed and it is never necessary to add water.

## Electronics:

A solid-state charger is standard. Charger voltage is regulated to  $\pm 1\%$  of nominal system voltage. The charger is current limited and protected against short circuit and reverse polarity conditions. Transfer to emergency operation is completely automatic upon failure of utility AC voltage. A low voltage disconnect circuit prevents deep discharge damage to the unit battery during prolonged power outages. An AC lock-out prevents battery discharge before the unit is energized with AC power. Full battery recharge occurs in compliance with UL 924 specifications. A universal 120/277VAC, 60Hz input transformer, test switch and long life AC pilot light are all provided standard.

## Power Consumption

75 watts (maximum)

## Limited Warranty

| Description | Warranty In Years |         |          |
|-------------|-------------------|---------|----------|
|             | Unit Full         | Battery |          |
|             |                   | Full    | Pro-Rata |
| XPBP Series | 3                 | 3       | 3        |

Batteries must be placed in service or recharged within nine (9) months from factory shipment date. This warranty only applies when the product is used as intended. Any abuse or misuse contrary to normal installation or operation shall void this warranty.

## Suggested Specification

Self contained emergency lighting unit shall be Prescolite Life Safety Products model \_\_\_\_\_ explosion proof unit rated for operation in NEC Class \_\_, Division \_\_, Groups \_\_\_\_\_ environments. The unit's case shall be constructed of high strength, copper-free aluminum capable of containing any internal electrical arc or arc-generated explosions without subjecting the external hazardous environment to the by-products of any such occurrence. The unit will be provided with four mounting holes for attachment to a wall or other suitable surface. Housing shall be drilled and tapped for installation of utility AC conduit. Quick access to internal wiring and components will be provided by a thread-on cover. The unit shall supply the rated load for a minimum of 1 1/2 hours to not less than 87 1/2% of rated battery voltage. The unit shall be rated 120/277VAC, 60HZ and be listed by Underwriters Laboratories to Standard 924. The emergency power source shall be a fully rechargeable maintenance-free lead-acid battery. Electronics shall include a solid state charger with regulated charge voltage and short circuit protection. A low voltage disconnect and AC lockout will also be included. A test switch to check emergency operation and an AC "ON" indicator light shall be provided in a separate module. Accessory explosion-proof lighting fixtures model number shall be provided for (unit) (remote) mounting.

## Product Selector Guide

| Base Catalog Numbers | Electrical   |              |              |         |         |         |               |                   |
|----------------------|--------------|--------------|--------------|---------|---------|---------|---------------|-------------------|
|                      | Output Volts | Battery Type | Output Watts |         |         |         | Standard Lamp | Remote Capability |
|                      |              |              | 1.5 Hours    | 2 Hours | 3 Hours | 4 Hours |               |                   |
| XPBP-75P             | 6            | Lead-Acid    | 75           | 57      | 42      | 28      | (*)           | Yes               |
| 12XPBP-75P           | 12           | Lead-Acid    | 75           | 57      | 42      | 28      | (*)           | Yes               |

(\*) Unit supplied standard without lighting fixtures. See technical data sheet EL-43 for optional lighting fixtures and accessories.